

Getting there

Train information: www.sydneytrains.info

Bus information: transportnsw.info/travel-info/ways-to-get-around/bus

You will need to purchase either a multiple use Opal card (transportnsw.info/tickets-opal/opal) or single trip Opal tickets (transportnsw.info/tickets-opal/opal/opal-single-tickets) to use public transport. Opal single trip bus tickets can be purchased from the driver except on bus routes where an Opal card is required. Check the particular bus route timetable for information on whether a single trip Opal ticket may be purchased from driver. Return Opal tickets are unavailable.

The closest train stations to the University of Sydney are Redfern and Central stations. Redfern Station is within walking distance of the venue and takes about 15 to 20 minutes. See the walking route on the attached map.

Bus Routes

Buses travel between Central Station and the University of Sydney along Parramatta Road and City Road.

Central Station – University of Sydney (Parramatta Road)

Central Station to University of Sydney:

Board buses at Central Station, Railway Square, Stand M (bus stop id 200064). Alight at either the “University of Sydney Footbridge (205020)” or “University of Sydney Ross Street gate (205021)” stops.

University of Sydney to Central Station:

Board buses at Parramatta Road opposite “University of Sydney Ross Street gate (bus stop id 203768)” or “University of Sydney Footbridge (203769)” stops. Alight at Central Station, Railway Square.

Routes:

412, 413, 436, 438, 439, 440, 461, 480, 483, M10, L38 (stops University of Sydney Footbridge only) and L39 (stops University of Sydney Footbridge only).

Central Station – University of Sydney (City Road)

Central Station to University of Sydney:

Board buses at Central Station, Railway Square, Stand L (bus stop id 200063). Alight at “City Road before Butlin Avenue (200817)” stop.

University of Sydney to Central Station:

Board buses at City Road, city side of Eastern Avenue (bus stop id 205038). Alight at Central Station, Railway Square.

Routes:

422, 423, 426, 428, M30, L23 and L28.

Casual parking at the University of Sydney is very limited and it is suggested that you use public transport. [Sydney University Parking information.](#)

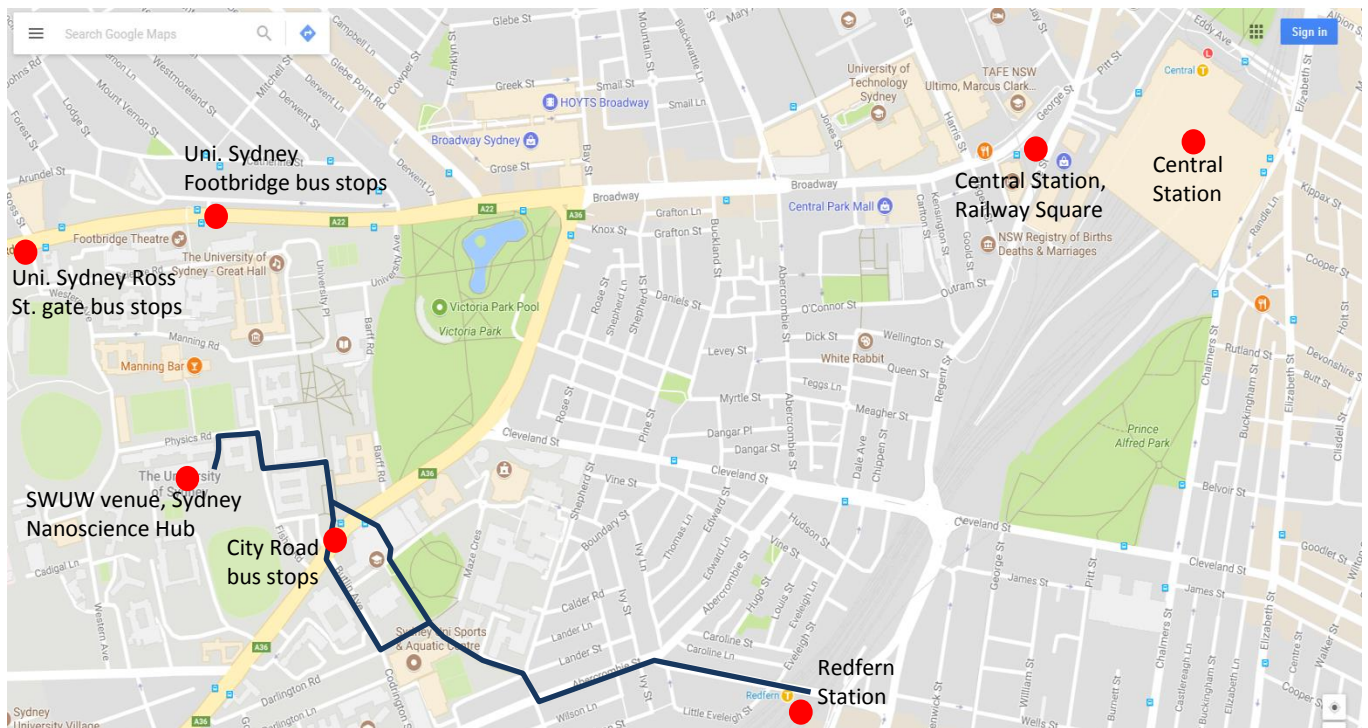

Directions for walking from Redfern Station

1. Turn left as you exit Redfern Station and walk along Lawson Street. Turn left into Abercrombie Street.
2. Turn right into Shepherd St.
3. You will see a footbridge where Lander Street crosses Shepherd Street. Walk along the footbridge.
- 4(a) For those less able to navigate stairs, turn left at either Maze Crescent South or further along the path and left into Maze Crescent. Turn right into Butlin Avenue then cross City Road (Princes Hwy) at the traffic lights into the main campus on Eastern Avenue.
- 4(b) Otherwise, continue walking along the path to the Wentworth building directly in front of you. Walk up the flight of stairs and continue up the right flight of stairs to a concrete courtyard. Walk across the courtyard towards City Road and walk up the stairs at the north-west corner of the courtyard. Walk across the City Road footbridge.
5. Travel along Eastern Avenue footpath and turn left between the School of Geosciences and School of Chemistry buildings. Turn right onto Fisher Road.
6. Travel past the Edward Ford Building and turn left into Physics Road.
7. The Sydney Nanoscience Hub is a new building behind the School of Physics building. Access is between the back of the Edward Ford Building and Physics Building in Physics Road.
8. Walk up the exterior stairs of the Sydney Nanoscience Hub to level three or alternatively enter the building from the courtyard between the Nanoscience Hub and Physics Buildings and use the lift to level three.

Sydney Nanoscience Hub (SNH) off Physics Road behind School of Physics, University of Sydney, Camperdown campus, Sydney

Access between Edward Ford and School of Physics buildings on Physics Road.

Level 3, SNH Lecture Theatre 4002 (Messel) and Level 3 SNH Seminar Room 3001.

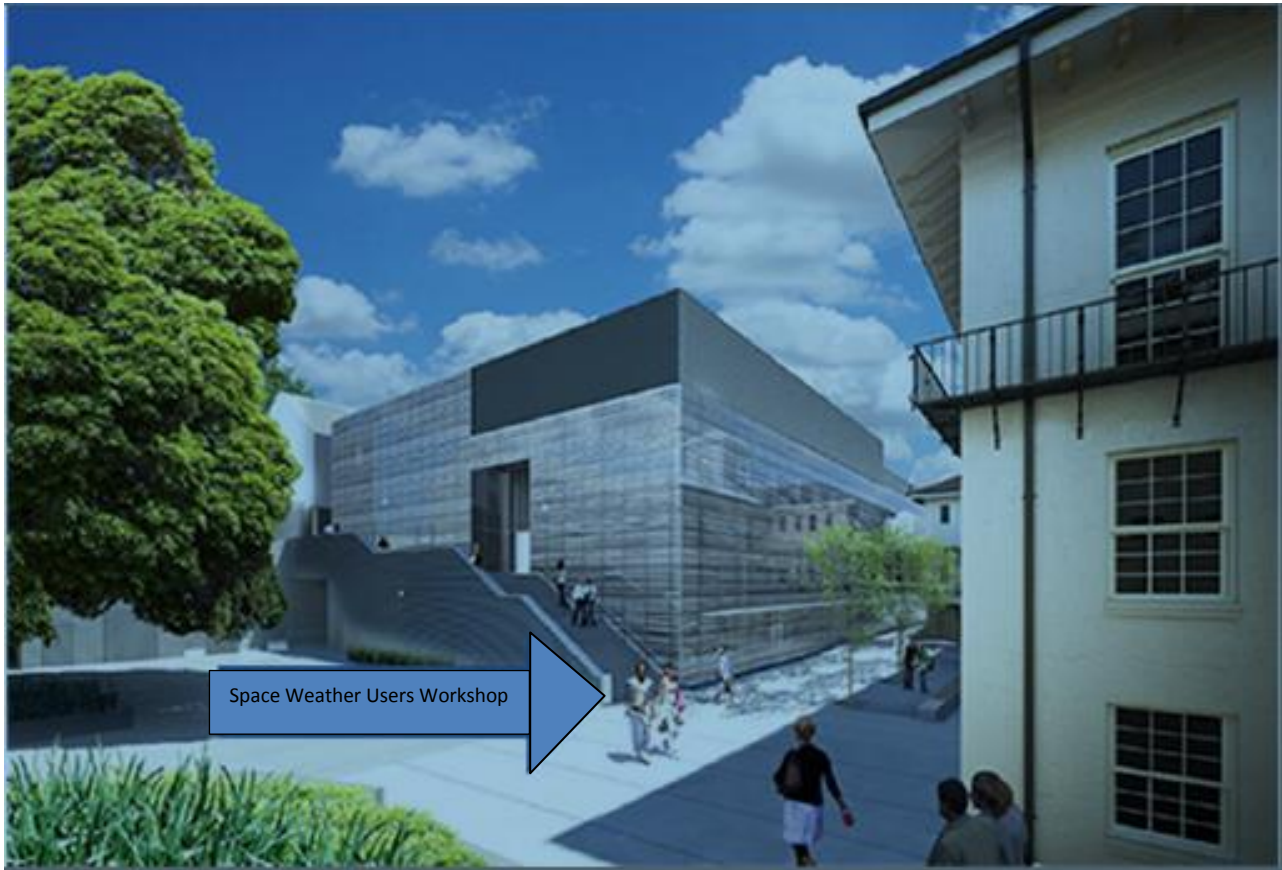

[Detailed map of the University of Sydney.](#)

[University of Sydney campus map information.](#)